

Company:
 Address:

 Contact person:
 Tel.:
 E-mail:

Working direction:

- Compression**
Normally open
- Traction**
Normally closed

Gas spring type:

- Normal**
- Flexible blockable**
in both direction
- Rigid blockable**
in compression
- Rigid blockable**
in extension

Gas spring dimensions:

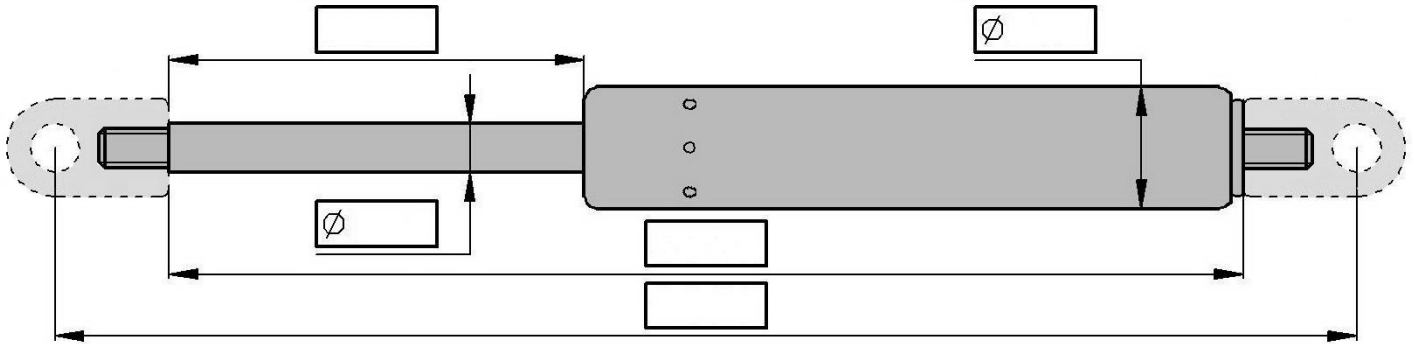

Text on the gas spring:

Rod end fitting

End fittings and dimensions:

Cylinder end fitting

	<input type="checkbox"/>	Thread	<input type="checkbox"/>	
	<input type="checkbox"/>	Release pin for blockables	<input type="checkbox"/>	
	<input type="checkbox"/>	Eyelet	<input type="checkbox"/>	
	<input type="checkbox"/>	Rod end bearing	<input type="checkbox"/>	
	<input type="checkbox"/>	Clevis	<input type="checkbox"/>	
	<input type="checkbox"/>	Clevis + pin	<input type="checkbox"/>	
	<input type="checkbox"/>	Plastic ball socket	<input type="checkbox"/>	
	<input type="checkbox"/>	Plastic ball socket + pin	<input type="checkbox"/>	
	<input type="checkbox"/>	Steel ball socket	<input type="checkbox"/>	
	<input type="checkbox"/>	Steel ball socket + pin	<input type="checkbox"/>	

Force:

Accessories:

- Safety lock**
Locks in open position

- Protective cover**
Prevent rod damage

Quantity:

Operating temperature:

- Low**
min.: -45°C max.: +80°C

- Normal**
min.: -30°C max.: +80°C

- High**
min.: -30°C max.: +200°C

Deadline:

Versions and appearance:

- Normal (Basic)**
Black rod and tube

- Silver**
Chrome rod, silver tube

- Inox**
Stainless rod and tube

Other informations:

.....